

IRIDE TURBO LO

323RA02L11



Descrizione del prodotto / Product description

Incasso LED per interni ed esterni

Corpo realizzato in tornitura di alluminio con trattamento superficiale di anodizzazione nera.

Flangia superiore in Acciaio Inox AISI316L o Bronzo Naturale.

Ottica ad emissione spot in PMMA trasparente.

Schermo superiore tornito in PMMA trasparente.

Pressacavo posteriore IP68.

Power LED di potenza ad altissima efficienza CRI ≥90.

Cavo di collegamento in neoprene. Fornito con sistema di connessione rapida termoretraibile (vedi istruzioni di montaggio).

LED projector for indoor / outdoor.

Body made of turning aluminum with black anodized treatment.

Upper flange made of Stainless Steel AISI316L or Natural Bronze.

Spot optics made of clear PMMA.

Upper screen made of turned clear PMMA.

Rear co-printed cable gland IP68.

Power LED with very high efficiency CRI ≥90.

Neoprene connection cable.

Supplied with heat shrink fast connection system (see assembly instructions)

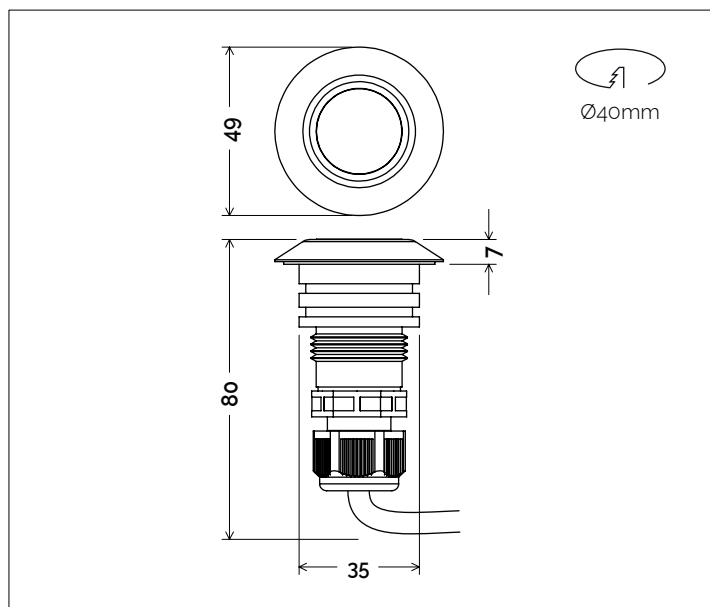

Dati tecnici | Technical Info

* su richiesta / on requests

Finiture | Finishes

- **1002** Acciaio Inox AISI 316L
Satinato
Satin Stainless Steel AISI 316L
- **1012** Bronzo Naturale | Natural
Bronze
- Verniciati RAL | RAL Paintings*

Potenza | Power 5W

Corrente | Current -

Tensione | Voltage 24Vdc

Tolleranza cromatica | Chromatic
tolerance 3 SDCM

Flusso luminoso | Luminous Flux 515lm

Mantenimento del flusso lumi-
noso | Flux Maintenance ≥50.000h

Temperature di esercizio | Ope-
rating temperature -20° ~ 45°

Simbologia tecnica Technical informations

	Conforme alle direttive CE
	Conforme alle normative RoHS
	Classe III
	Indice di Protezione IP67
	Connettore stagno in dotazione

Temperatura di Colore Color Temperature

9027 - 2700K CRI 92
9030 - 3000K CRI 92
9040 - 4000K CRI 92

Ottiche Optics

	N1 -8° (Very Narrow Beam)
	N3 -12° (Narrow Beam)
	F1 -30° (Flood Beam)
	W1 -45° (Wide Flood Beam)
	E1 -15°x45° (Elliptical Beam)

Sistemi di Controllo Control System

	On / Off (remoto escluso / remote excluded)
	PUSH * (remoto escluso / remote excluded)
	1-10V * (remoto escluso / remote excluded)
	DALI * (remoto escluso / remote excluded)

Creazione Codice | Code construction

323RA02L11-XXXX-XX-XXXX

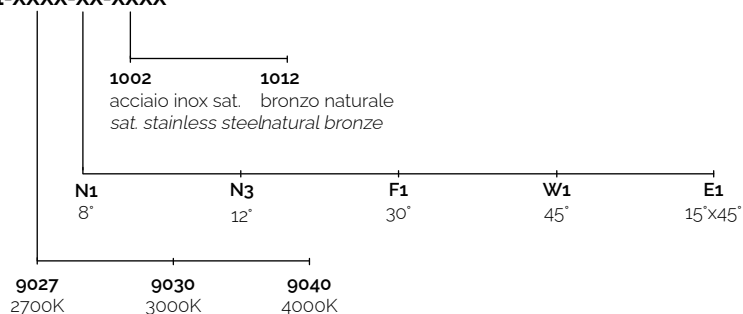

Dati Fotometrici | Photometric Specification

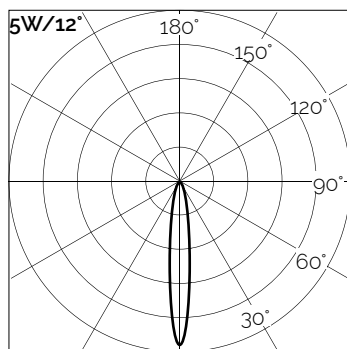

h (m)	E (lx)	D (cm)
1	6129	21
1.5	2801	31
2	1578	42
2.5	1011	52
3	707	63

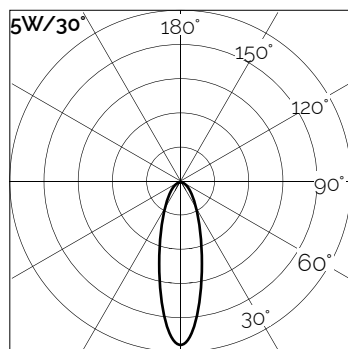

h (m)	E (lx)	D (cm)
1	1642	53
1.5	732	80
2	411	107
2.5	263	133
3	184	160

Accessori | Accessories

9A001

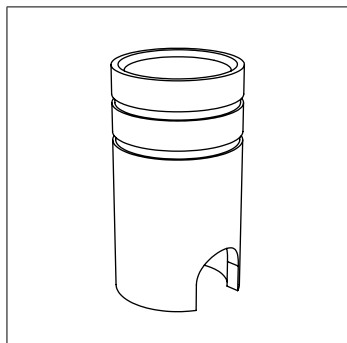

Cassaforma per incasso
(Ø44mm H.80mm)

Recessed Box
(Ø44mm H.80mm)

9A002

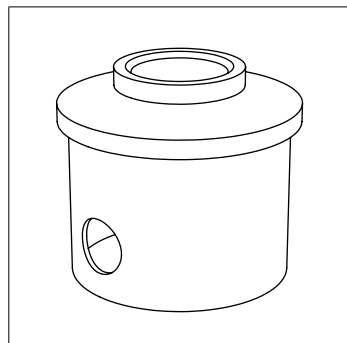

Cassaforma maggiorata per
incasso
(Ø90mm H.80mm)

Large Recessed Box
(Ø90mm H.80mm)

9F005

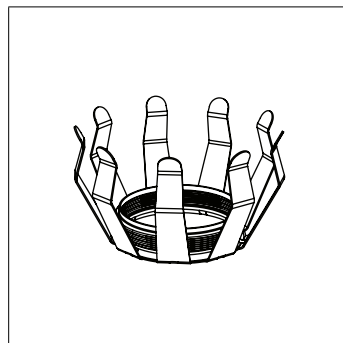

Molla di fissaggio.
(foro su pannello Ø40mm)

Fixing Spring.
(hole on panel Ø40mm)

Alimentatori | *Led*

Tipo Alim. / Driver Type	potenza / power	tensione / voltage	dimensioni / dimensions	n. prodotti	IP	codice / code
ON/OFF	10W	24Vdc	39x22x75mm	2	20	9M301
	14W	24Vdc	38x25x79mm	2	67	9M401
DALI2	60W	24Vdc	35x53x150mm	1 ~10	67	9M805